

Board of Commissioners

75 Langley Drive • Lawrenceville, GA 30046-6935
770.822.7000 • www.gwinnettcounty.com

Charlotte J. Nash, Chairman
Jace W. Brooks, District 1
Lynette Howard, District 2
Tommy Hunter, District 3
John Heard, District 4



Official

Informal Briefing Minutes
Tuesday, July 18, 2017 – 10:30 AM

Present: Charlotte J. Nash, Jace Brooks, Lynette Howard, John Heard
Absent: Tommy Hunter

I. Financial Services

SPLOST Update

Financial Service Director/CFO Maria Woods, Community Services Director Tina Fleming, and Explore Gwinnett/Infinite Energy Center CEO Preston Williams provided an overview of 2017 SPLOST Program projects. No Official Action Taken.



gwinnettcounty
GOVERNMENT

2017 SPLOST Program

July 18, 2017



2017 SPLOST Highlights

- 6 year program
- Estimated to raise \$950 million
- Shared between Gwinnett County (78.76%) and 16 cities (21.24%)
- \$34 million of County's share set aside for joint projects with the cities
- Approved by voters in November 2016 (62.6% in favor)



2017 SPLOST Program

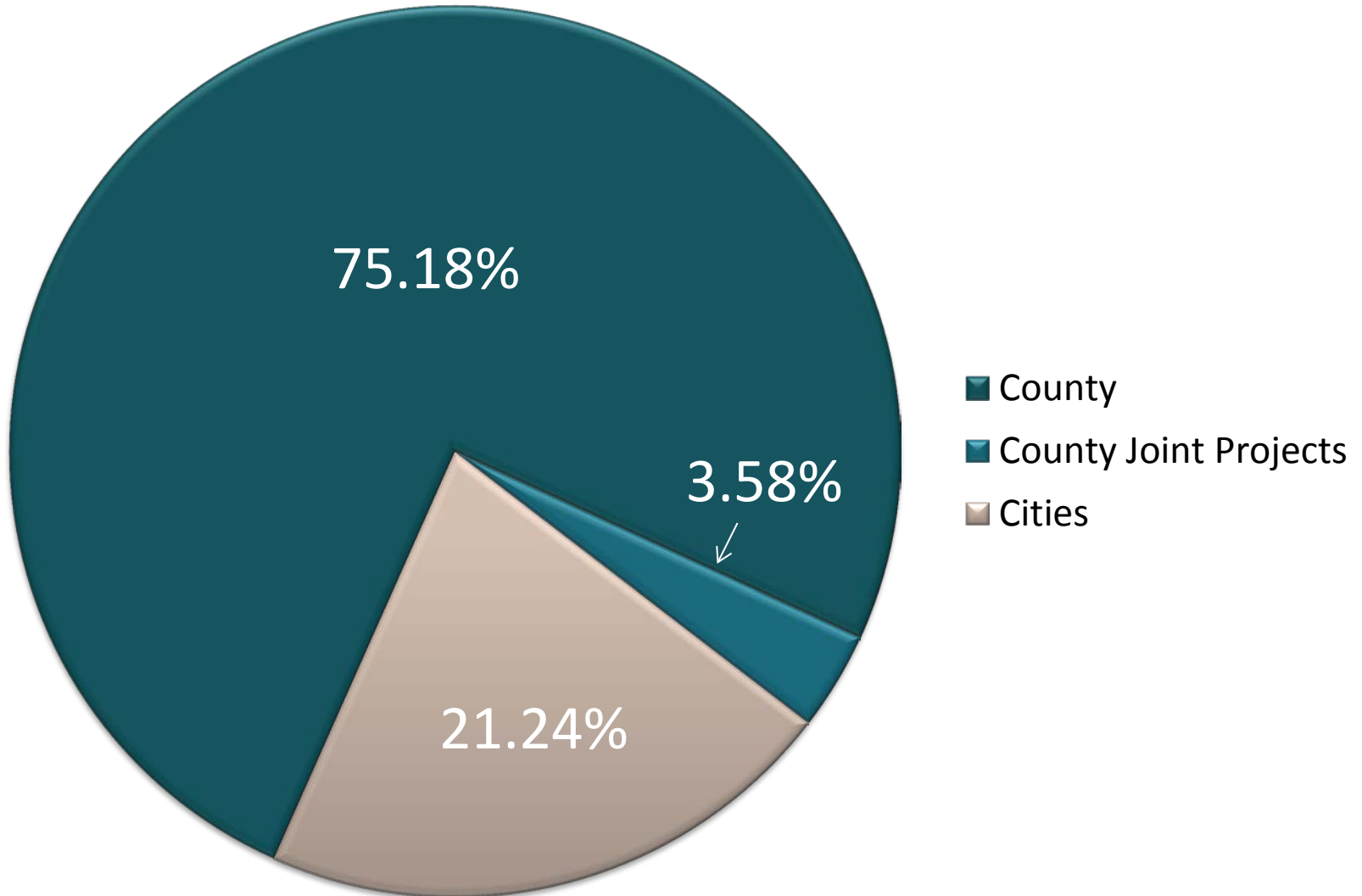



Allocation by Category Total Program

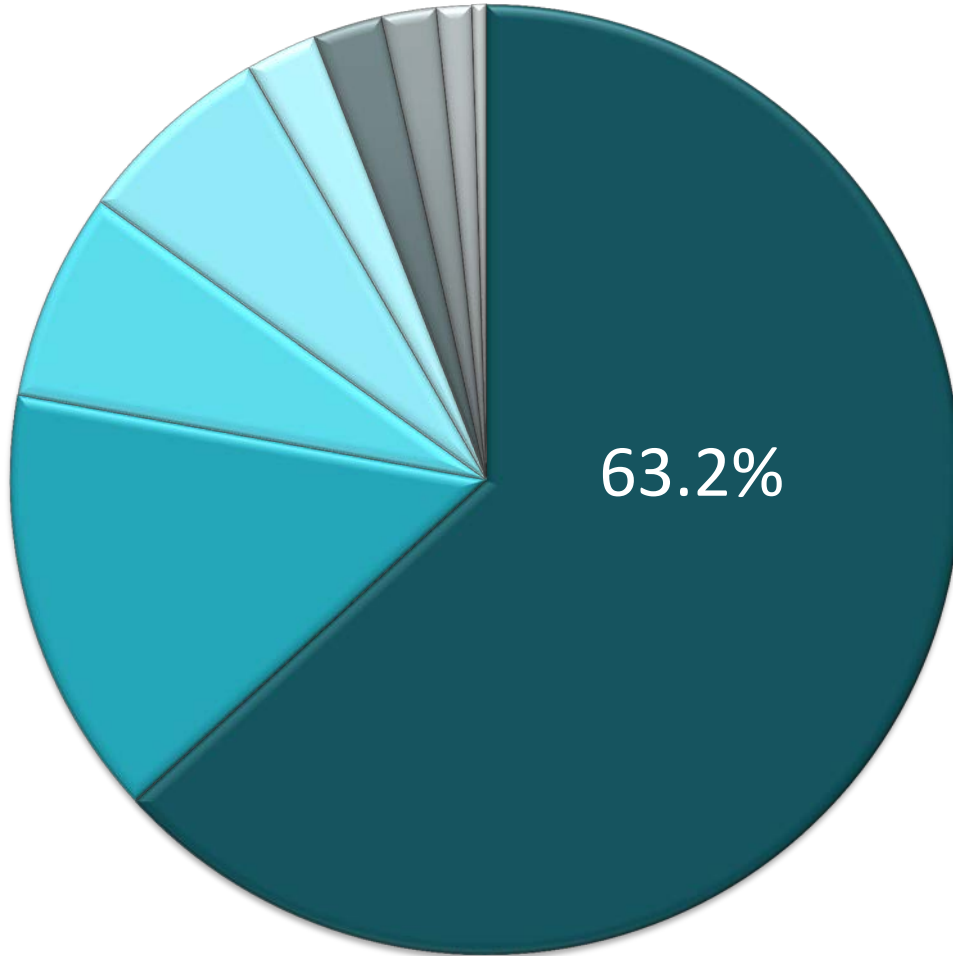

- Transportation
- Recreational Facilities/Equipment
- Conference Center Expansion
- Public Safety Facilities/Equipment
- City Parking Facilities
- Relocation of Library Facilities
- City Cultural Facilities
- Senior Service Facilities
- City Other



Allocation by Category

County Portion - \$748.2M

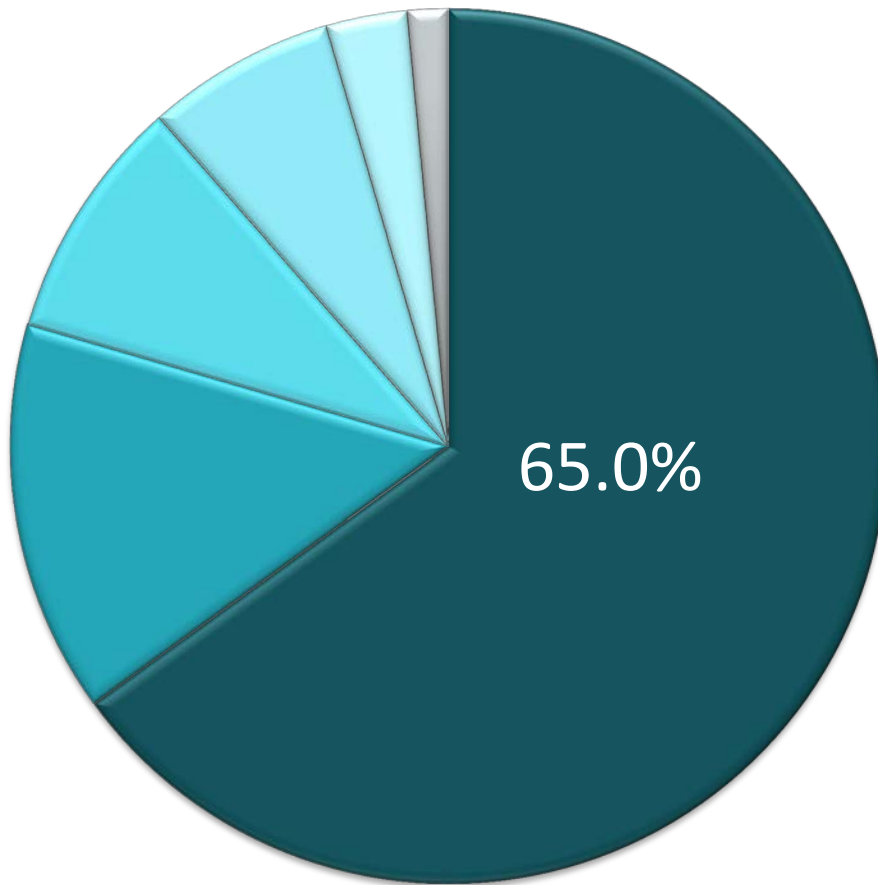

- Transportation
- Recreational Facilities/Equipment
- Conference Center Expansion
- Public Safety Facilities/Equipment
- Relocation of Library Facilities
- Senior Service Facilities/Equipment

Gwinnett County website www.gwinnettsplost.com

gwinnettcounty government

Mobile Site | Contact Us | A-Z Index | FAQ | Site Map | Login

ABOUT GWINNETT SERVICES DEPARTMENTS CALENDAR NEWS EMPLOYMENT TOP LINKS

Access Online Services

SPLOST

Board of Commissioners

- Mission, Vision, Values
- Public Meetings
- 2013 Budget
- 2012 Budget
- 2011 Budget
- About Your Commissioners
- Notices, Agendas, & Minutes
- Archive: Agendas & Minutes
- Budget & Financial Reports
- Commission Meetings
- Commission Meeting Videos
- County Clerk
- District Map
- Ethics Ordinance
- Homeowners Associations
- Municipal Codes
- Organization Chart
- Service Districts Explained
- SPLOST
 - History & Overview
 - Transportation
 - Parks & Greenspace
 - Public Safety & Courts
 - Libraries
 - Cities Share
 - Citizen Involvement
 - E-SPLOST
 - SPLOST Video
- State of the County
- Your Money

Departments > Board of Commissioners > SPLOST

your pennies at work **SPLOST** special purpose local option sales tax

Special Purpose Local Option Sales Tax

Gwinnett voters have approved a series of Special Purpose Local Option Sales Tax programs, known as SPLOST, since the mid-1980s. This one percent sales tax has paid for County and city facilities, acres of greenspace, parks and recreation facilities, new roads and improvements, police and fire stations, and libraries around the county. Your pennies are working to keep Gwinnett a great play to live, work, and play!

Find Out Where Your Pennies Go

- SPLOST history & overview**
- SPLOST your pennies for transportation**
- SPLOST your pennies for parks & greenspace**
- SPLOST your pennies for public safety & courts**
- SPLOST your pennies for libraries**
- SPLOST your pennies for city share**
- SPLOST citizen involvement**
- E-SPLOST your pennies for education**



COMMUNITY
SERVICES

Special Purpose Local Option Sales Tax

gwinnettcounty
GOVERNMENT



SPLOST

Total: \$97,642,800

Funding is directed to categories identified in the 2017 Parks and Recreation Capital Update:



Smart & Sustainable
Government

Recreation Authority Board discussed, voted, approved February 9, 2017



City/County Share

Total: \$3,154,230

- **City of Snellville – \$1 million**
 - Town Center Trail improvements and Oak Road Neighborhood Park
- **City of Loganville – \$141,879**
 - Destination Park improvements
- **City of Lilburn –\$509,228**
 - Camp Creek Greenway improvements
- **City of Dacula –\$18,518**
 - general trail maintenance and furnishings
- **City of Suwanee – \$820,317**
 - Project to be determined
- **City of Norcross – \$664,288**
 - Pinnacle Park improvements



Greenways

Total: \$10 million

- Harbins to Tribble Mill Park-Phase I
- Upper Sweetwater Greenway
- Ivy Creek Greenway
- Singleton Greenway
- Johnson Greenway



Safe & Healthy
Community



Mobility & Access



A Strong & Vibrant
Local Economy





Park Development (New)

Total: \$26,510,000

- New park development
- Park expansions
- Historic sites



Communication &
Engagement



Smart & Sustainable
Government



Park Development (New)

Parks & Recreation SPLOST: \$3.75 million

- Beaver Ruin Wetland Park



Communication & Engagement



Smart & Sustainable Government



Park Development (New)

Historic Sites: \$5 million

- Hudson-Nash House
- McGuire-Livsey Big House



Communication &
Engagement





Park Development (New)

Community Park Total: \$6.4 million

- Alexander Park – Phase II
- Lenora Park
 - Community Recreation Center Expansion



Exceptional
Livability & Comfort



Safe & Healthy
Community





Park Development (New)

Expansion Total: \$5.76 million

- **Dacula Park**

- Gymnasium and Senior Wing Expansion
- \$3.8 million Senior SPLOST



Exceptional
Livability & Comfort



Safe & Healthy
Community



SITE PLAN



AERIAL VIEW 1



AERIAL VIEW 2

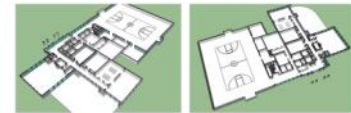

SCHEME 4 PLAN



Park Land Acquisition

Total: \$9.3 million

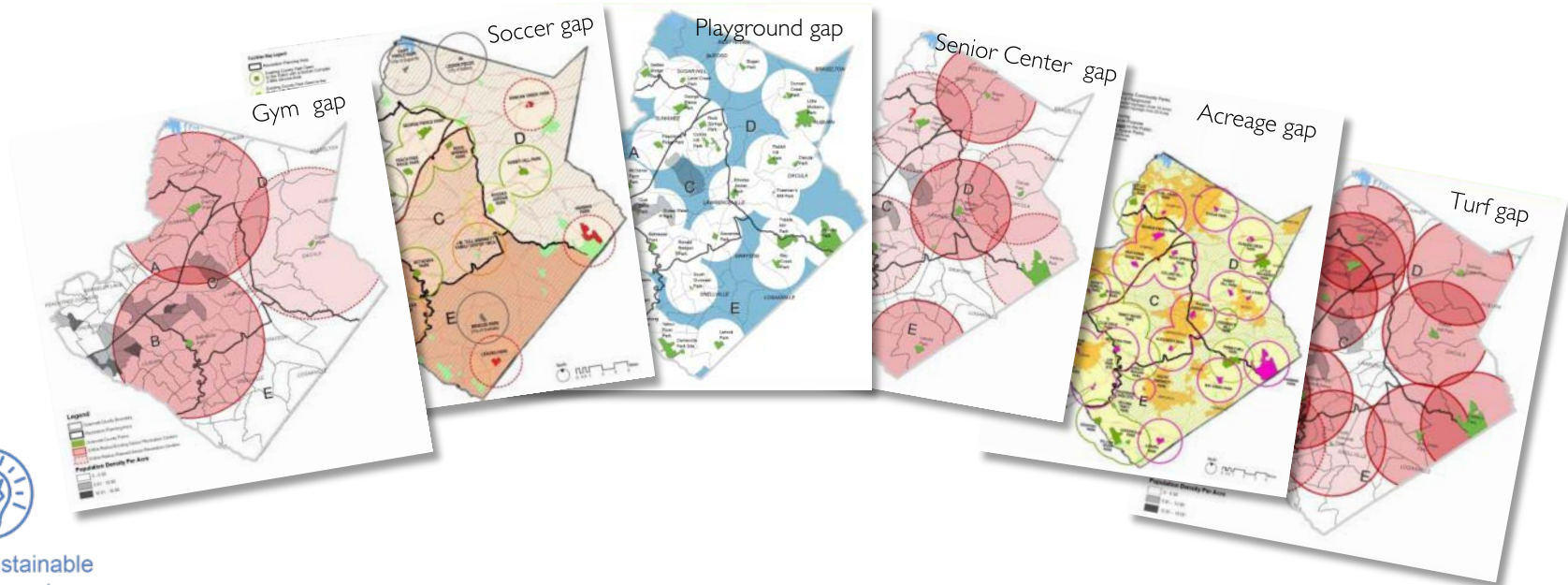



Park Renovations & Improvements

Total: \$31,561,000

- Asset Management

\$25,711,000



Safe & Healthy
Community



Smart & Sustainable
Government





Park Renovations & Improvements

- Artificial Turf Conversion
 - Rhodes Jordan Park
 - Dacula Park
 - Shorty Howell Park
 - Rock Springs Park
 - Lenora Park



Smart & Sustainable
Government



Safe & Healthy
Community



Gwinnett Environmental & Heritage Center

Total: \$15 million

- Adaptive Tree Canopy
- Improvements to GEHC



Communication & Engagement



Mobility & Access



A Strong & Vibrant Local Economy

**INCLUSION
INSPIRATION
INTERACTION
EDUCATION**

LEGEND:

- ① Universal environmental permit
- ② ADA compliant
- ③ ADA accessible
- ④ ADA table
- ⑤ ADA ramp
- ⑥ ADA sign
- ⑦ ADA parking
- ⑧ ADA rest

ENVIRONMENTAL & HERITAGE CENTER INCLUSIVE TREEHOUSE



COMMUNITY
SERVICES

Questions?

gwinnettcounty
GOVERNMENT



ZONE 3

ZONE 2

EXISTING CONVENTION CENTER AND BALLROOM RENOVATION

EXHIBIT HALL EXPANSION

SERVICE DRIVE IMPROVEMENTS & TEMP. PARKING

ARENA DECK UPGRADES

ARENA SEAT EXPANSION

SECURITY PLAZA

THEATER

ROTUNDA BUILDING AND LANDSCAPE

HOTEL AND CONFERENCE CENTER

LAKE DEVELOPMENT AND LANDSCAPE

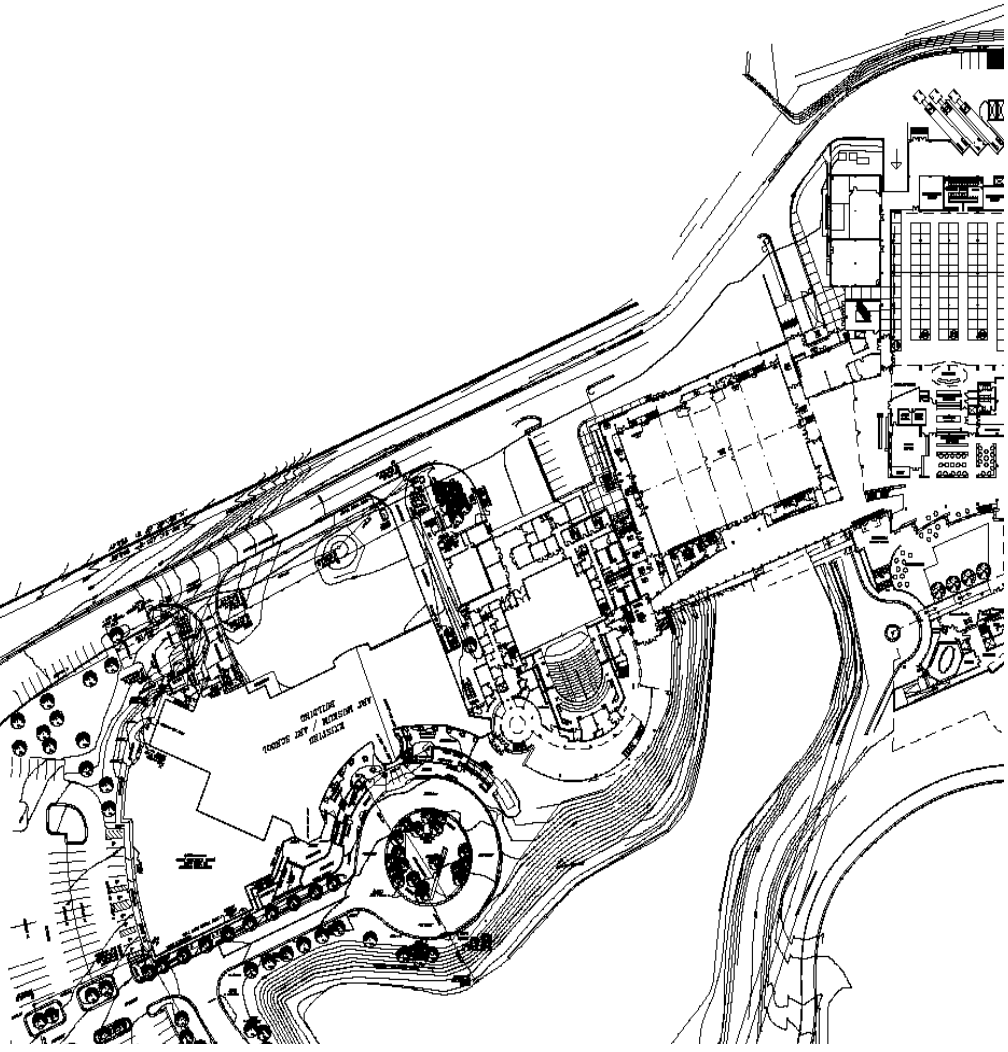

Lower Concourse

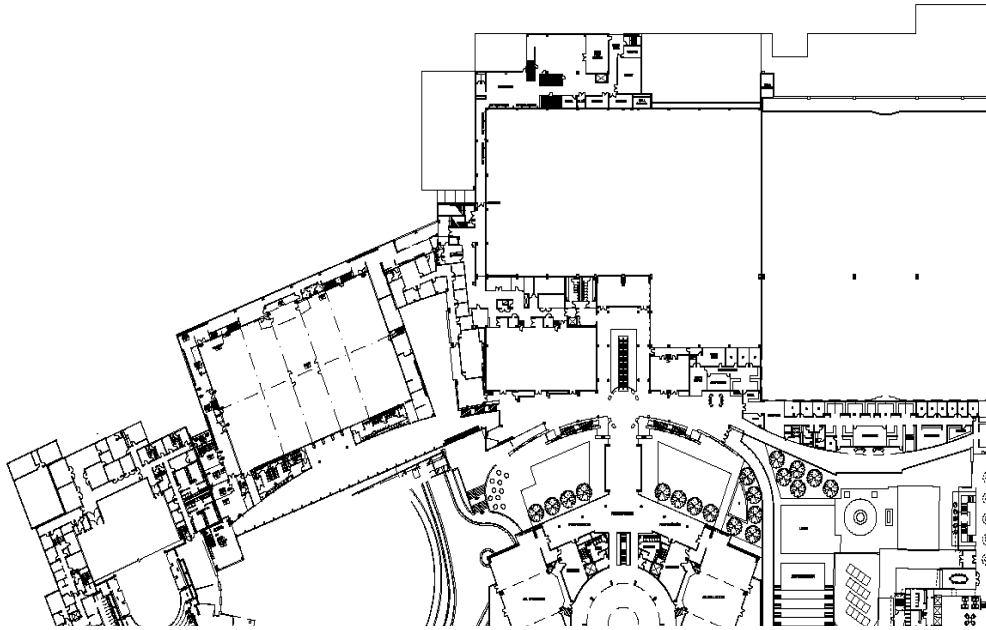

Upper Concourse Level

